



Lewin Road, SW16 6JU

- One double bedroom
- Communal garden
- Open plan living
- Close to wide array of local amenities
- Recently modernised
- Superb transport links into The City

Offers in Excess of

Lewin Road, SW16 6JU

Oaks of Streatham are delighted to bring to the market this bright and light one bedroom flat on Lewin Road. The property has been recently modernised and comprises of an open plan kitchen/living room, double bedroom and bathroom. Set over the first floor of a period building this property benefits from a number of period features. Lewin Road is ideally positioned being on a quiet and treelined street yet being a few hundred meters from Streatham Common Station with direct access to Clapham Junction and London Victoria. The shops, bars and restaurants of Streatham high road are within easy reach of the property including the well regarded Mere Scribbler and Railway pubs.



LEWIN ROAD

APPROXIMATE GROSS INTERNAL FLOOR AREA: 351 SQ FT - 32.60 SQ M

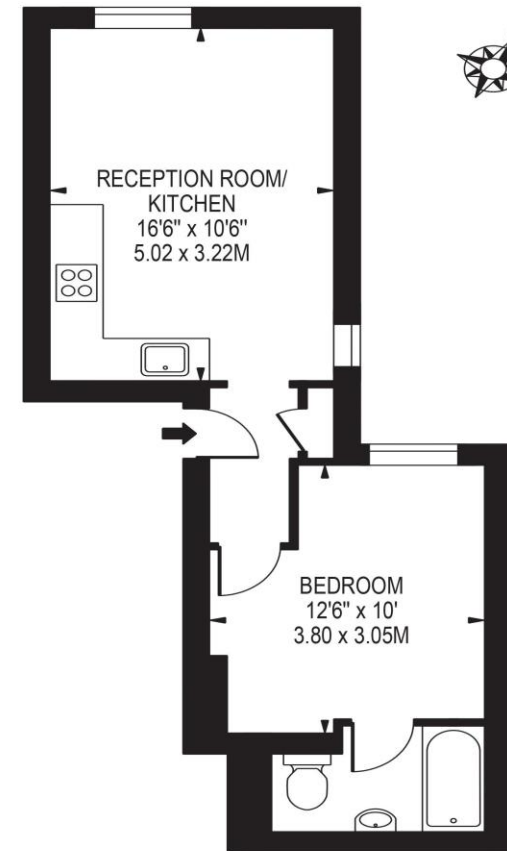

FIRST FLOOR

FOR ILLUSTRATION PURPOSES ONLY

THIS FLOOR PLAN SHOULD BE USED AS A GENERAL OUTLINE FOR GUIDANCE ONLY AND DOES NOT CONSTITUTE IN WHOLE OR IN PART AN OFFER OR CONTRACT. ANY INTENDING PURCHASER OR LESSEE SHOULD SATISFY THEMSELVES BY INSPECTION, SEARCHES, ENQUIRIES AND FULL SURVEY AS TO THE CORRECTNESS OF EACH STATEMENT. ANY AREAS, MEASUREMENTS OR DISTANCES QUOTED ARE APPROXIMATE AND SHOULD NOT BE USED TO VALUE A PROPERTY OR BE THE BASIS OF ANY SALE OR LET.

Telephone 020 3780 0000
Website oaksestateagents.com
Email streatham@oaksestateagents.com

