



Rowan Crescent SW16 5JB

£525,000

- Three Bedrooms
- 1930's Family Home
- Separate Reception Rooms

- Excellent Local Amenities
- Great Transport Links
- No Onward Chain

Oaks 

Rowan Crescent SW16 5JB

Independent estate agents of Streatham Oaks are delighted to offer to the market this well-presented 1930's family home. Excellently positioned within close proximity for good local amenities in the area. This delightful property comprises of three bedrooms, generously sized reception rooms, modern kitchen with access to a large manicured garden and large garage. Further benefiting from being offered with no onward chain this property is ideal for those looking for a family home without having to compromise on catchment areas or transport links.



Telephone 020 3780 0000
Website oaksestateagents.com
Email streatham@oaksestateagents.com

Rowan Crescent

Approx. Gross Internal Area 908 Sq Ft - 84.35 Sq M
(Excluding Store)
Approx. Gross Internal Area Of Store 59 Sq Ft - 5.50 Sq M

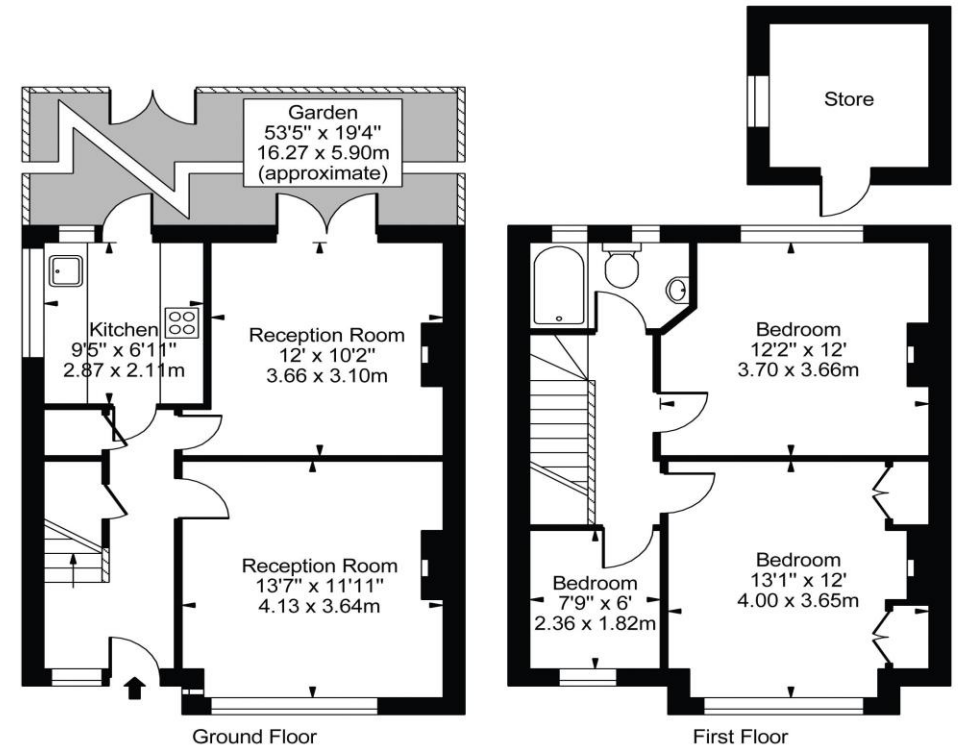

For Illustration Purposes Only - Not To Scale

This floor plan should be used as a general outline for guidance only and does not constitute in whole or in part an offer or contract. Any intending purchaser or lessee should satisfy themselves by inspection, searches, enquiries and full survey as to the correctness of each statement. Any areas, measurements or distances quoted are approximate and should not be used to value a property or be the basis of any sale or let.

