



Kettering Street, SW16 6PZ

£485,000

- Two bedrooms
- Large open plan living space
- Heart of Furzedown area
- Potential to extend into the loft
- Maisonette
- Private garden

Kettering Street, SW16 6PZ

A wonderfully located two-bedroom top floor flat set on the quiet yet well connected Kettering Street. The maisonette is accessed by its own front door and comprises; two well-proportioned double bedrooms, large open plan kitchen/living room with space for dining, a large family bathroom and steps down to a well-maintained private garden. This wonderful home has been well maintained and modernised by the current owners, it would be perfect for a first-time buyer or home mover looking for an extra bedroom. The property further benefits from the potential to do a loft extension (STPP). The flat is ideally located in the heart of the Furzedown area with access to Streatham Common, Streatham and Tooting Bec stations station with direct access to Clapham Junction, Balham, London Victoria, and London Bridge.



KETTERING STREET

APPROXIMATE GROSS INTERNAL FLOOR AREA: 737 SQ FT - 68.47 SQ M

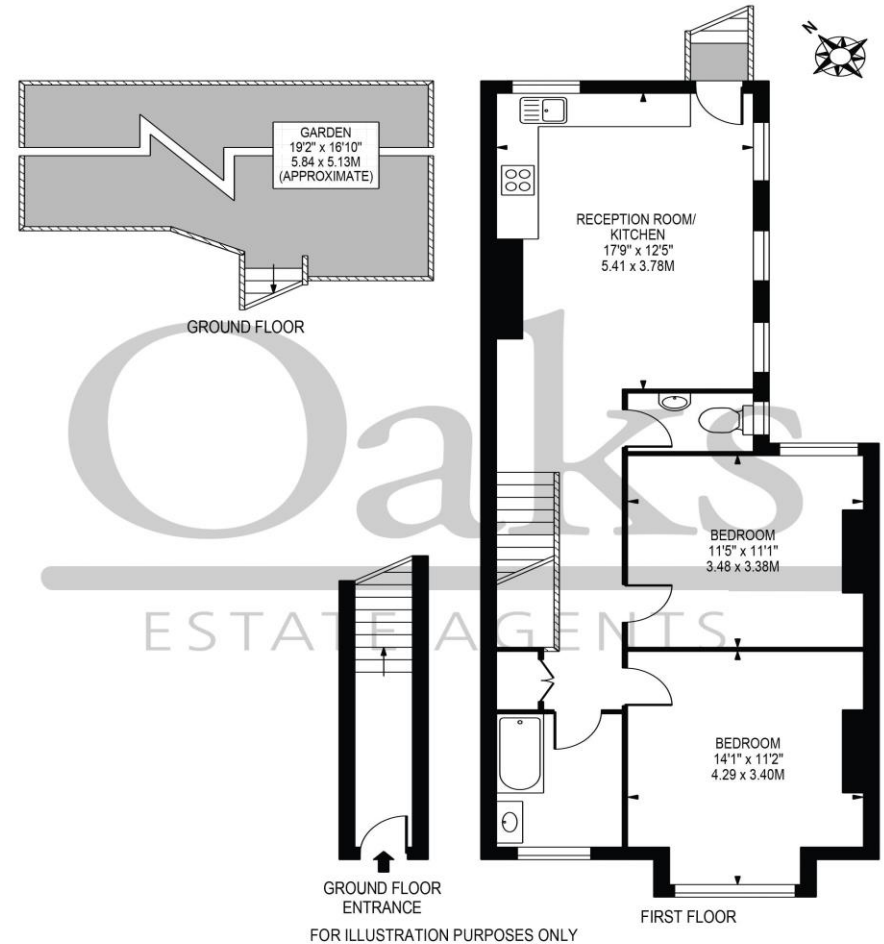

THIS FLOOR PLAN SHOULD BE USED AS A GENERAL OUTLINE FOR GUIDANCE ONLY AND DOES NOT CONSTITUTE IN WHOLE OR IN PART AN OFFER OR CONTRACT. ANY INTENDING PURCHASER OR LESSEE SHOULD SATISFY THEMSELVES BY INSPECTION, SEARCHES, ENQUIRIES AND FULL SURVEY AS TO THE CORRECTNESS OF EACH STATEMENT. ANY AREAS, MEASUREMENTS OR DISTANCES QUOTED ARE APPROXIMATE AND SHOULD NOT BE USED TO VALUE A PROPERTY OR BE THE BASIS OF ANY SALE OR LET.

Telephone 020 3780 0000
Website www.oaksestateagents.com
Email streatham@oaksestateagents.com