



Maple Mews, SW16 2AL

- Top floor flat
- Well connected property
- One large double bedroom

- Flooded with natural light
- Separate modern kitchen
- Set in a quiet yet well-located Mews

Offers in Excess of £300,000

Maple Mews, SW16 2AL

A spectacular purpose built flat with amazing views out over central London. The well-appointed property comprises of one double bedroom with built in storage, separate kitchen complete with integrated units, large living room and a well-maintained bathroom. This top floor home has been meticulously looked after by the current owners and is flooded with natural light. The property is ideally located between Streatham and West Norwood Stations with direct access to Clapham Junction, Balham, London Victoria, and London Bridge. The shops, bars and restaurants of Streatham high road and West Norwood are within easy reach of the property including an M&S and Aldi. In addition, the wide, open and leafy Streatham Common is just a short walk away from the property



MAPLE MEWS

APPROXIMATE GROSS INTERNAL FLOOR AREA: 475 SQ FT - 44.13 SQ M

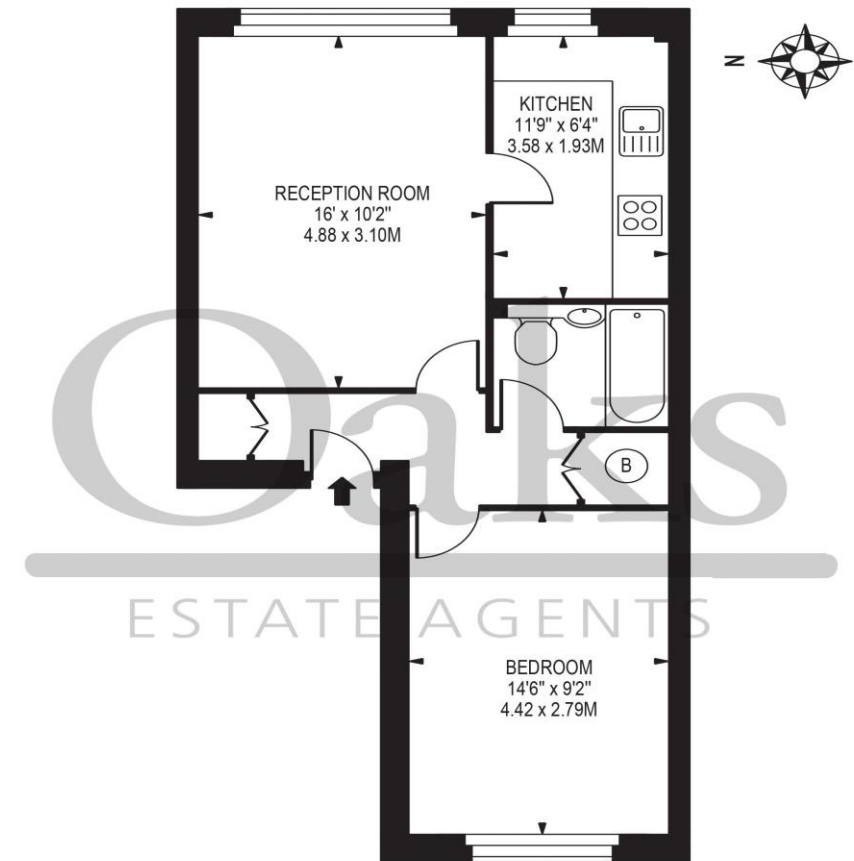

SECOND FLOOR

FOR ILLUSTRATION PURPOSES ONLY

THIS FLOOR PLAN SHOULD BE USED AS A GENERAL OUTLINE FOR GUIDANCE ONLY AND DOES NOT CONSTITUTE IN WHOLE OR IN PART AN OFFER OR CONTRACT. ANY INTENDING PURCHASER OR LESSEE SHOULD SATISFY THEMSELVES BY INSPECTION, SEARCHES, ENQUIRIES AND FULL SURVEY AS TO THE CORRECTNESS OF EACH STATEMENT. ANY AREAS, MEASUREMENTS OR DISTANCES QUOTED ARE APPROXIMATE AND SHOULD NOT BE USED TO VALUE A PROPERTY OR BE THE BASIS OF ANY SALE OR LET.

Telephone 020 3780 0000
Website www.oaksestateagents.com
Email streatham@oaksestateagents.com

