



## Barcombe Avenue, SW2 3BA

- One bedroom garden flat
- Large open plan living/ kitchen
- South facing garden
- Chain free property
- Period property
- Close to Streatham Hill Station

Offers in Excess of £425,000



# Barcombe Avenue, SW2 3BA

A beautiful conversion flat set within the confines of an imposing property in the Streatham Hill area. The well-appointed property comprises of a large double bedroom with built in storage, family bathroom, semi open kitchen and living room and a beautiful south facing garden accessed directly from the kitchen. This home has been meticulously looked after by the current owners and benefits from a number of period features throughout and is flooded with natural light from large windows. The flat is ideally located near to Streatham Hill Station with direct access to Clapham Junction, Balham, London Victoria, and London Bridge. The shops, bars and restaurants of Streatham high road are within easy reach of the property including an M&S food hall.



Telephone 020 3780 0000  
Website [www.oaksestateagents.com](http://www.oaksestateagents.com)  
Email [streatham@oaksestateagents.com](mailto:streatham@oaksestateagents.com)

## BARCOMBE AVENUE

APPROXIMATE GROSS INTERNAL FLOOR AREA: 479 SQ FT - 44.51 SQ M

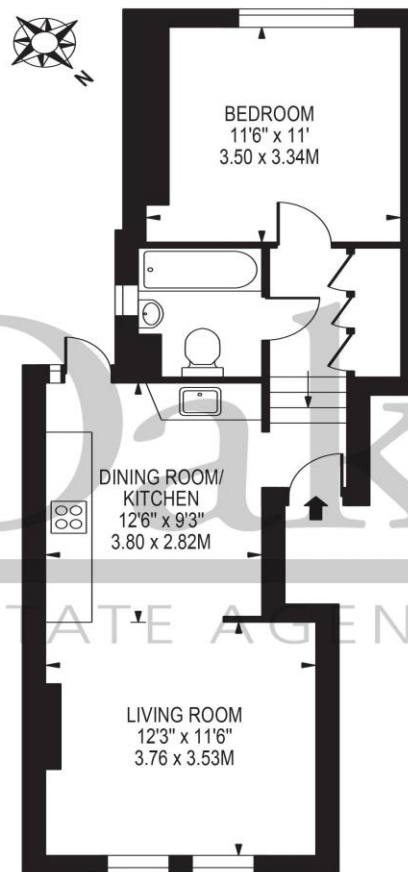

GROUND FLOOR

FOR ILLUSTRATION PURPOSES ONLY

THIS FLOOR PLAN SHOULD BE USED AS A GENERAL OUTLINE FOR GUIDANCE ONLY AND DOES NOT CONSTITUTE IN WHOLE OR IN PART AN OFFER OR CONTRACT. ANY INTENDING PURCHASER OR LESSEE SHOULD SATISFY THEMSELVES BY INSPECTION, SEARCHES, ENQUIRIES AND FULL SURVEY AS TO THE CORRECTNESS OF EACH STATEMENT. ANY AREAS, MEASUREMENTS OR DISTANCES QUOTED ARE APPROXIMATE AND SHOULD NOT BE USED TO VALUE A PROPERTY OR BE THE BASIS OF ANY SALE OR LET.