



Dalmally Road

CR0 6LZ

Monthly rental of £1550

- Available immediately
- 778 sq. ft. of living space
- Three well-proportioned bedrooms
- Popular residential road
- Excellent transport links to The City
- Close to wide array of popular local amenities



Dalmally Road CR0 6LZ

Oaks Estate Agents are delighted to present to the market this three bedroom house, ideal home for a growing family. Located on a quiet and sought-after residential road in the heart of Addiscombe, the property offers an impressive 778 sq. ft. of living space. Light and airy throughout, Dalmally Road briefly comprises; three well-proportioned bedrooms, reception room, dining room, modern fitted kitchen and a family bathroom. Offered unfurnished, the property could not be better placed for any commuter requiring access into The City for work. East Croydon station is a short tram ride away and offers convenient access into London via Clapham Junction, Victoria and London Bridge in one direction and Gatwick and Brighton in the other. Addiscombe Tram Stop is close by and links you to Wimbledon and Beckenham. In addition to the excellent transportation, the property is located close to Lower Addiscombe Road's excellent local businesses, Croydon town centre and a whole host of well-regarded amenities including Boxpark. With demand expected to be high, we thoroughly recommend an internal viewing to avoid disappointment and to fully comprehend just how stunning this home really is.



Telephone 0203 989 8361
Website www.oaksestateagents.com
Email croydonlettings@oaksestateagents.com

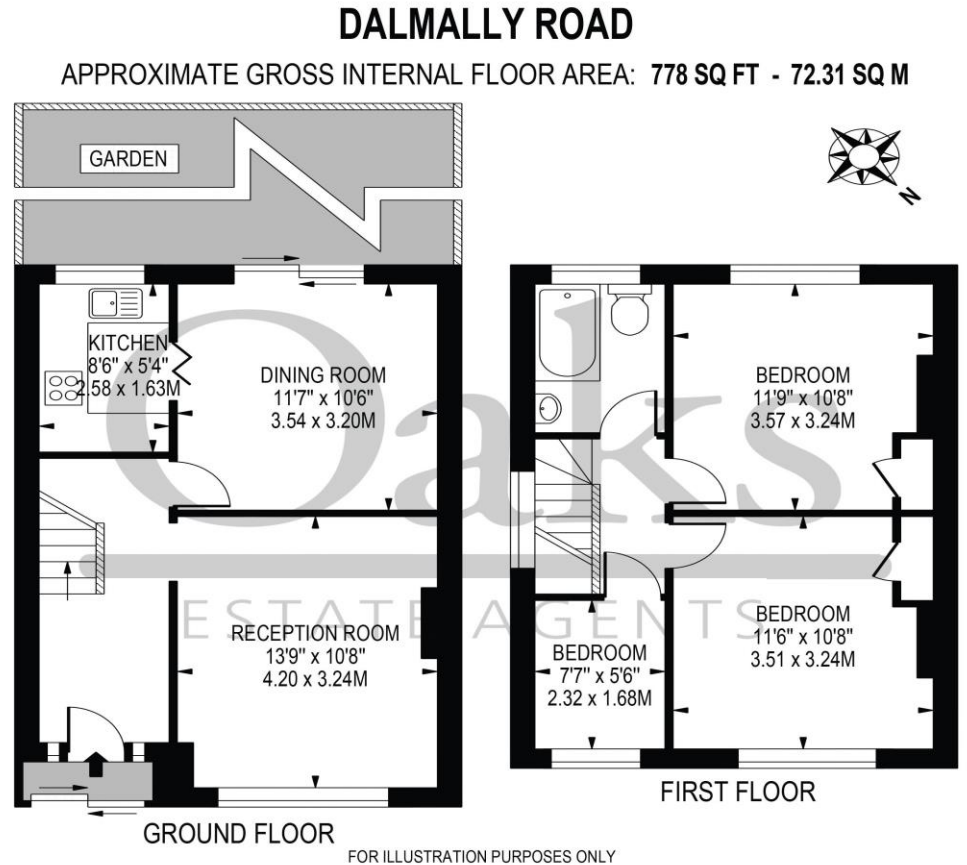

THIS FLOOR PLAN SHOULD BE USED AS A GENERAL OUTLINE FOR GUIDANCE ONLY AND DOES NOT CONSTITUTE IN WHOLE OR IN PART AN OFFER OR CONTRACT. ANY INTENDING PURCHASER OR LESSEE SHOULD SATISFY THEMSELVES BY INSPECTION, SEARCHES, ENQUIRIES AND FULL SURVEY AS TO THE CORRECTNESS OF EACH STATEMENT. ANY AREAS, MEASUREMENTS OR DISTANCES QUOTED ARE APPROXIMATE AND SHOULD NOT BE USED TO VALUE A PROPERTY OR BE THE BASIS OF ANY SALE OR LET.

