



Besley Street, SW16 6BD

£525,000

- Two double bedrooms
- Set on a quiet road
- Potential to add value
- Large sunny garden
- Open plan living
- Period home

Besley Street, SW16 6BD

A beautiful two bedroom house set on a quiet road in the heart of Streatham. This stunning period home benefits from a number of original features and would provide the perfect opportunity for a buyer to put their own stamp on this home. It comprises; a open large living/dining room that is flooded with natural light, a modern kitchen complete with integrated units, two bedrooms, an upstairs family bathroom and a garden to the rear. The chimneys have been taken out to create more space throughout the property. This lovely home would suit any commuter requiring access into The City due its close proximity to Streatham Common station with direct access to central London Via London Bridge and London Victoria. Besley Street is positioned close to a wide array of popular local amenities local to Streatham and is a walk from the wide, open and leafy spaces of Streatham and Tooting Commons.



Telephone 020 3780 0000
Website www.oaksestateagents.com
Email streatham@oaksestateagents.com

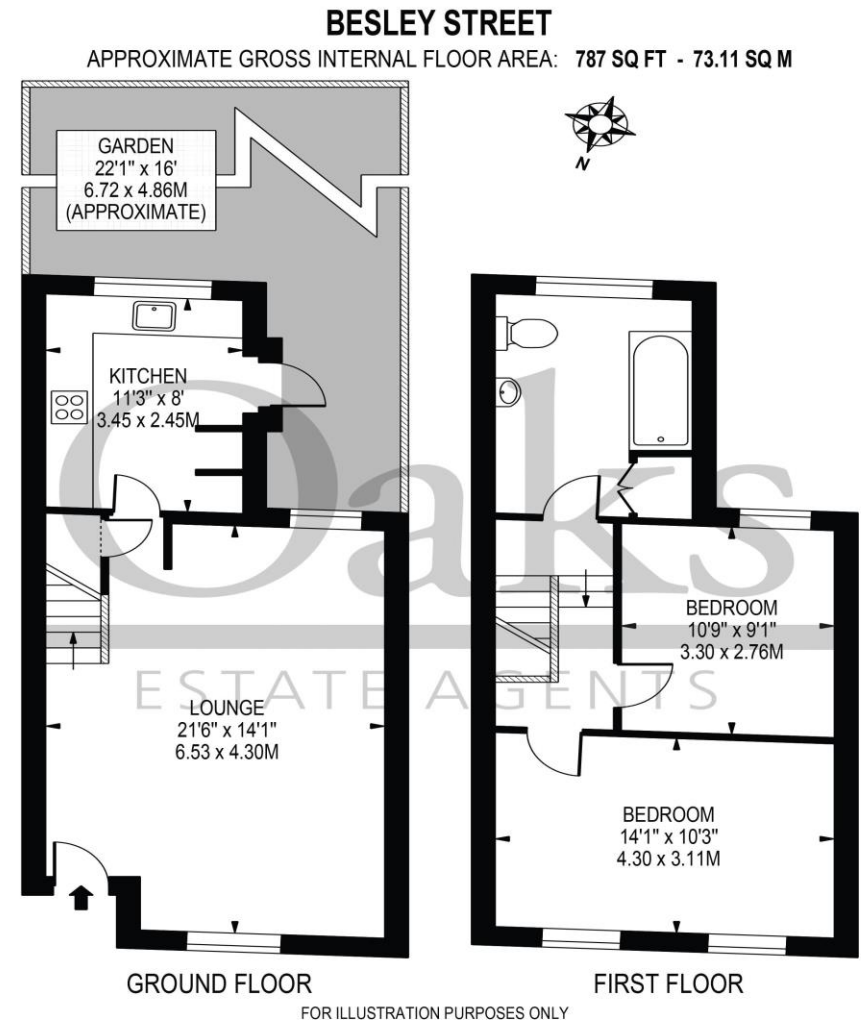

FOR ILLUSTRATION PURPOSES ONLY
THIS FLOOR PLAN SHOULD BE USED AS A GENERAL OUTLINE FOR GUIDANCE ONLY AND DOES NOT CONSTITUTE IN WHOLE OR IN PART AN OFFER OR CONTRACT.
ANY INTENDING PURCHASER OR LESSEE SHOULD SATISFY THEMSELVES BY INSPECTION, SEARCHES, ENQUIRIES AND FULL SURVEY AS TO THE CORRECTNESS OF EACH STATEMENT.
ANY AREAS, MEASUREMENTS OR DISTANCES QUOTED ARE APPROXIMATE AND SHOULD NOT BE USED TO VALUE A PROPERTY OR BE THE BASIS OF ANY SALE OR LET.