



Park Avenue, CR4 2ES

- Three-bedroom flat
- Split level flat
- Chain free
- Share of freehold
- Set on a quiet street
- Private garden

Offers in Excess of £425,000

Park Avenue, CR4 2ES

A wonderfully located split level flat set within a beautiful period property. This home benefits from an impressive amount of living space and comprises; three well-proportioned double bedrooms, large open plan kitchen/living room with plenty of space for dining, a large family bathroom and a private garden to the rear. This wonderful home has been well maintained and modernised by the current owner and it would be perfect for a first-time buyer or home mover looking for outdoor space or potential for a home office. The flat is ideally located in the Furzedown area with access to Streatham Common, Streatham and Tooting Bec station with direct access to Clapham Junction, Balham, London Victoria, and London Bridge via Northern and Overground links. The shops, bars and restaurants local to Mitcham lane, Tooting and Streatham High Road are within easy reach of the property including numerous well regarding pubs. The property also sits between the leafy, wide-open spaces of both Streatham and Tooting Commons.



Telephone 020 3780 0000
Website oaksestateagents.com
Email streatham@oaksestateagents.com

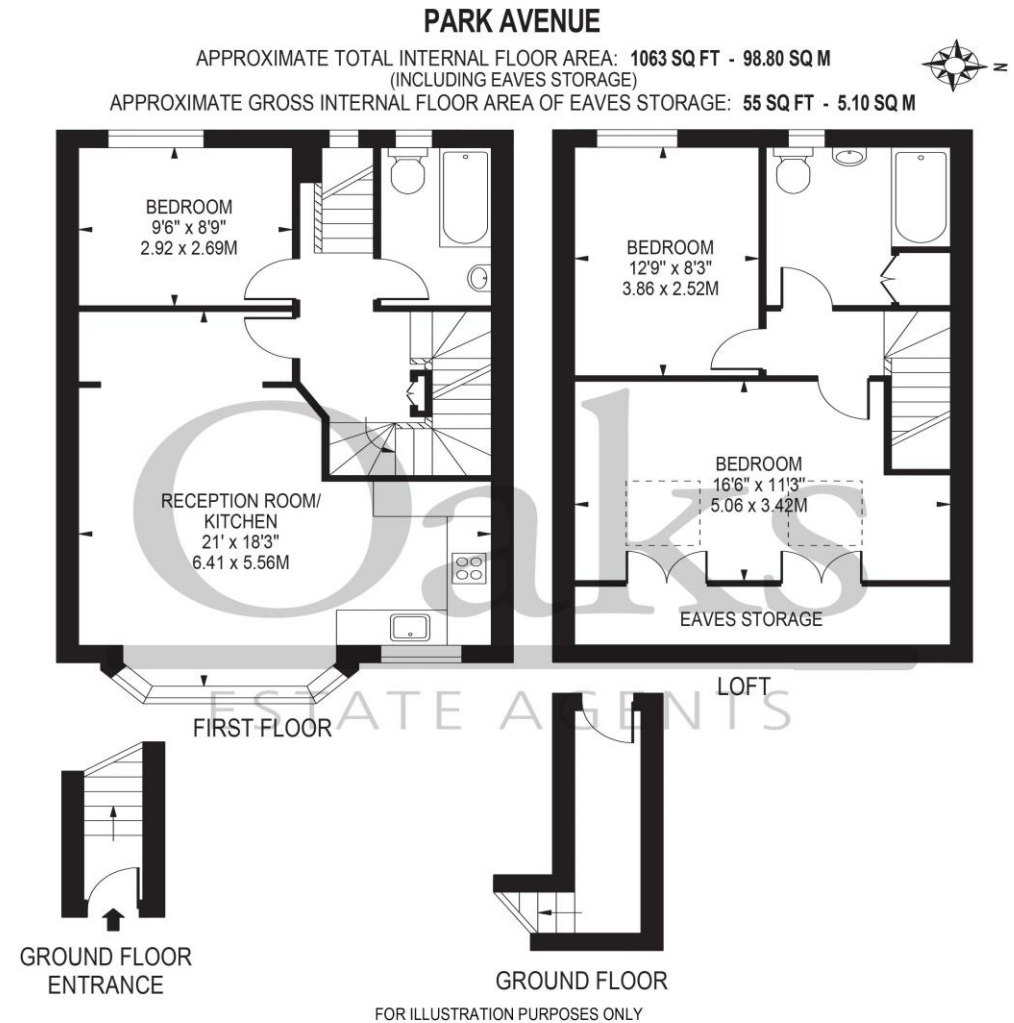

THIS FLOOR PLAN SHOULD BE USED AS A GENERAL OUTLINE FOR GUIDANCE ONLY AND DOES NOT CONSTITUTE IN WHOLE OR IN PART AN OFFER OR CONTRACT. ANY INTENDING PURCHASER OR LESSEE SHOULD SATISFY THEMSELVES BY INSPECTION, SEARCHES, ENQUIRIES AND FULL SURVEY AS TO THE CORRECTNESS OF EACH STATEMENT. ANY AREAS, MEASUREMENTS OR DISTANCES QUOTED ARE APPROXIMATE AND SHOULD NOT BE USED TO VALUE A PROPERTY OR BE THE BASIS OF ANY SALE OR LET.