

Hepworth Road, SW16 5DH

- Three bedroom house
- Potential to extend
- Separate dining room
- Quiet location
- Close to transport
- Large garden to the rear

£575,000

Hepworth Road SW16 5DH

A beautiful three bedroom house set on the quiet and sought after Hepworth Road. well cared for and extended by the current owners this freehold property benefits from an impressive amount of living space it is in good decorative order and comprises; three bedrooms with plenty of storage, a well maintained family bathroom, cosy living room, separate kitchen and a dining room which opens onto a garden to the rear. The property could be extend into the large loft space and to the rear (STPP). It would suit any commuter requiring access into The City due to its close proximity to Norbury, Streatham and Streatham Common stations which provide direct access to Clapham Junction, Victoria, London Bridge and Farringdon. Hepworth Road also benefits from electrical car charging points on the street. The wide, leafy and open spaces of Streatham Common are a short walk away as are the shops, bars and restaurants local to Streatham High Road including the well regarded Bull and Railway pubs. Also, Granton, Woodmansterne and Immanuel schools are within easy reach. The property is offered with vacant possession and is chain free.



HEPWORTH ROAD

APPROXIMATE GROSS INTERNAL FLOOR AREA: 1054 SQ FT - 97.90 SQ M

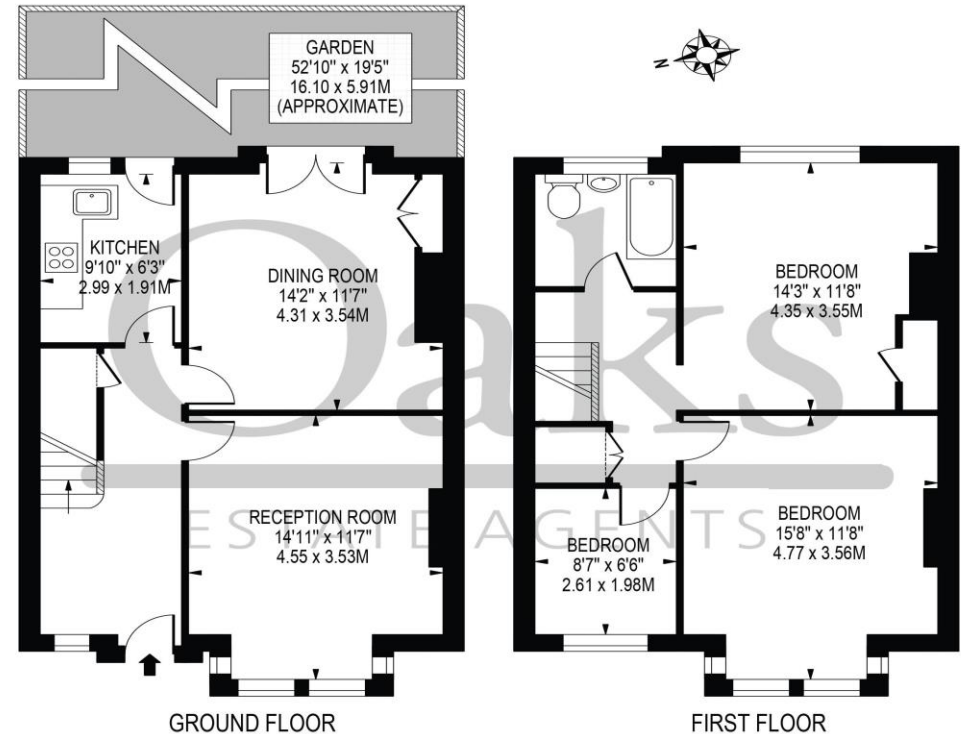

FOR ILLUSTRATION PURPOSES ONLY

THIS FLOOR PLAN SHOULD BE USED AS A GENERAL OUTLINE FOR GUIDANCE ONLY AND DOES NOT CONSTITUTE IN WHOLE OR IN PART AN OFFER OR CONTRACT. ANY INTENDING PURCHASER OR LESSEE SHOULD SATISFY THEMSELVES BY INSPECTION, SEARCHES, ENQUIRIES AND FULL SURVEY AS TO THE CORRECTNESS OF EACH STATEMENT. ANY AREAS, MEASUREMENTS OR DISTANCES QUOTED ARE APPROXIMATE AND SHOULD NOT BE USED TO VALUE A PROPERTY OR BE THE BASIS OF ANY SALE OR LET.

Telephone 020 3780 0000
Website www.oaksestateagents.com
Email streatham@oaksestateagents.com