



Grove Road, CR4 1AE

- Three bedroom house
- Detached
- Large rear garden
- Driveway
- Potential to extend
- EPC Rating: D

£450,000

Grove Road, CR4 1AE

A detached three bedroom home set on the well connected Grove Road. This property comprises; three well-proportioned bedrooms, family bathroom and an open plan living room/ kitchen which leads onto a wider than usual sunny garden. The property would be perfect for a first time buyer or home mover looking to put their stamp on this detached family home. It se also benefits from a driveway to the front with space for two cars. It would be an ideal purchase for a first time buyer or home mover looking for more space. The property is ideally located in Streatham Vale on the well connected Grove Road and is a short walk away from Streatham Common and Mitcham Eastfields stations with direct access to Central London via Clapham Junction, London Bridge and London Victoria. Woodmansterne School and Granton Primary School is a short walk away as are the shops, bars and restaurants local to Streatham Vale.



Telephone 020 3780 0000
Website oaksestateagents.com
Email streatham@oaksestateagents.com

GROVE ROAD

APPROXIMATE GROSS INTERNAL FLOOR AREA: 869 SQ FT - 80.73 SQ M

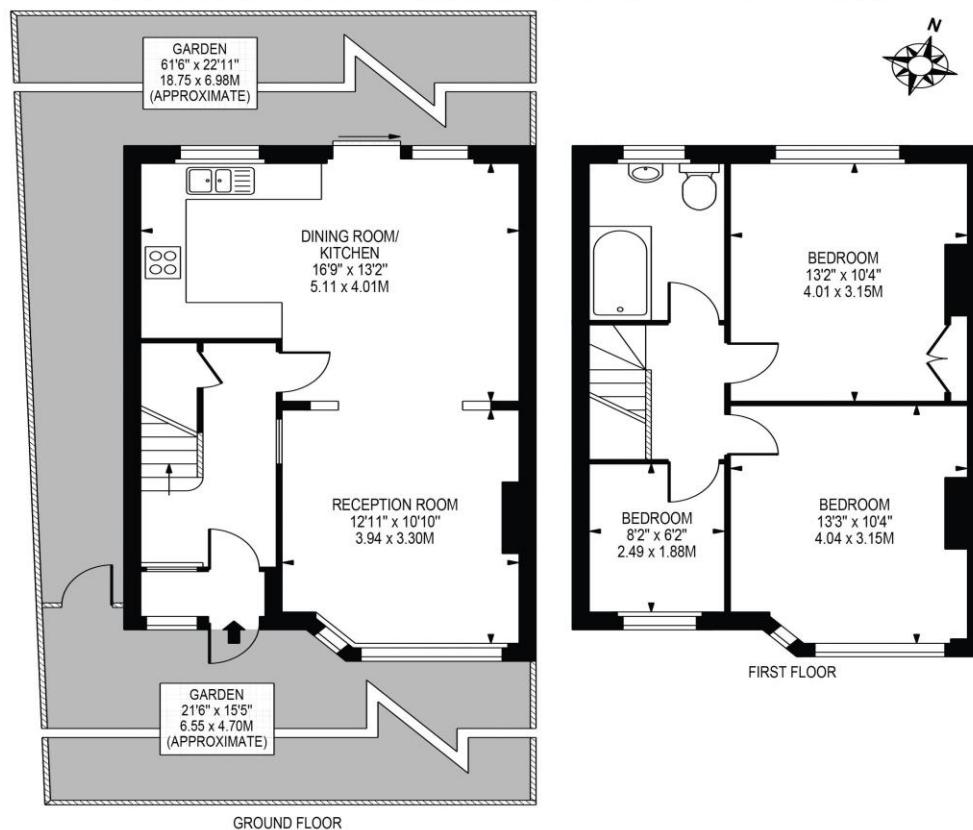

FOR ILLUSTRATION PURPOSES ONLY

THIS FLOOR PLAN SHOULD BE USED AS A GENERAL OUTLINE FOR GUIDANCE ONLY AND DOES NOT CONSTITUTE IN WHOLE OR IN PART AN OFFER OR CONTRACT. ANY INTENDING PURCHASER OR LESSEE SHOULD SATISFY THEMSELVES BY INSPECTION, SEARCHES, ENQUIRIES AND FULL SURVEY AS TO THE CORRECTNESS OF EACH STATEMENT. ANY AREAS, MEASUREMENTS OR DISTANCES QUOTED ARE APPROXIMATE AND SHOULD NOT BE USED TO VALUE A PROPERTY OR BE THE BASIS OF ANY SALE OR LET.